

NIKKI.AMSTERDAM

The.Diffuser User Manual

GENERAL SPECIFICATIONS

Input voltage	AC100-240V 50/60HZ
Power consumption	Max 12(W)
Max.Noise	36(dB)
Dimensions	(ψ)154x(H)188(mm)
Water tank capacity	300(ml)
Material	PP\leather
Accessories	Power Supply,measure cup,User Manual
Ultrasonic frequency	2.4MHz

GENERAL FEATURES

- Ultrasonic vapor diffuser maintains original efficacy of essential oils, instead of destroying their original molecular structure by heating or burning them.
- 2.4MHz Advanced Ultrasonic Technology.
- Timer : steady on, 1hour,3hours.
- LED models:7colors slow color changing,fixed single color select.
- Support smart phone application control.
- The smart phone operating system: Android and IOS.
- Compatible with Amazon Alexa, Google play.

PART NAMES

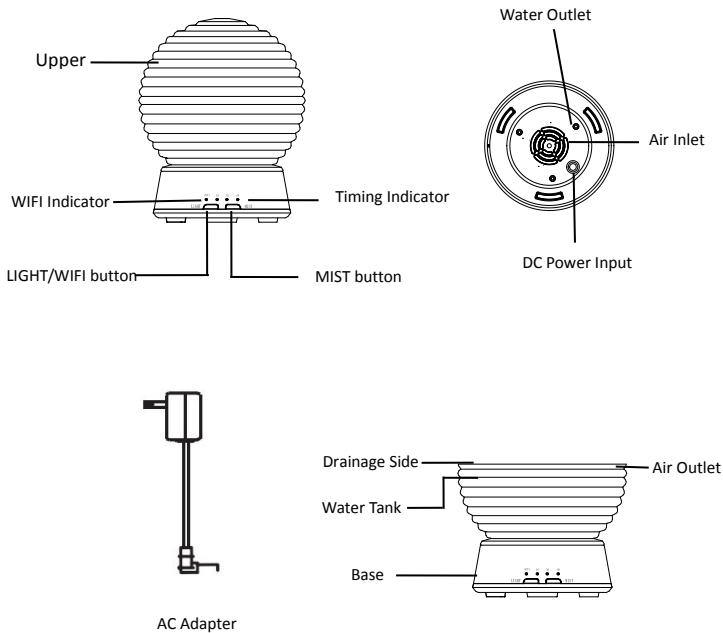

HOW TO USE

1.Put this product on a horizontal position, remove the upper vertical direction.Fig.1.

2.Connect the AC adaptor to the DC jack on the bottom of base.

3.① Add water to the tank. Pay attention to water level and do not exceed maximum level on water tank(Do not use water hotter than 45 ° C, to prevent damaging the atomizer; Do not use dirty water to prevent clogging and damaging the atomizer).

② Drop essential oil into water tank vertically. Quantity should be about 2-3 drops (about 0.1 – 0.15 ml. Use only water-soluble essential oils to guarantee good aroma-diffusion effect.) Fig. 3.

4.Replace the upper to the original position. Fig. 4.

Note:

You must close the upper when you want to use the product.

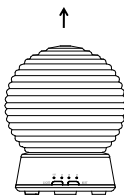

Fig.1

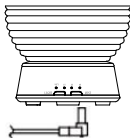

Fig.2



Fig.3

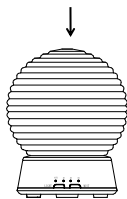

Fig.4

5. Press "MIST" button to choose your desired mode. Short press the "MIST" button to choose the timer from 1H/3H or ON. Keep pressing the "MIST" button over 5 seconds to choose the spray output between strong or small. Fig. 5.

Tips: The machine would be automatically detect water shortage and power-off protection.

6. "LIGHT" button (WIFI paring button).

① Press the "LIGHT" button to turn on the LED light, the color will change automatically. Press the "LIGHT" button again to fix the color. Fig. 6.

② WIFI paring function: Press and hold down "LIGHT" button, WIFI connection mode is on. If the WIFI indicator is always on, WIFI is in normal mode. If the WIFI indicator flashes, WIFI is into the pairing mode.

IMPORTANT TIPS:

Mist quantity gradually increases as water level decreases. However, when water reaches 1/3 water level, mist quantity begins reducing. This is normal, and is not a device malfunction. When water is completely depleted, the device turns off automatically and the indicator light goes out.

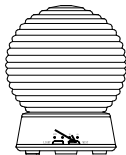

Fig.5

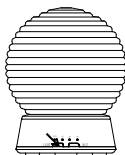

Fig.6

How to use the smart phone APP to control the device

1. Download the APP



Step 1: Scan QR Code And
Download Smart Life APP



Step 2: Register

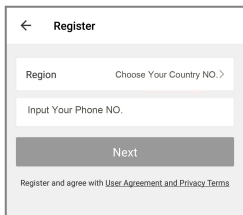

Step 3: Entry Account

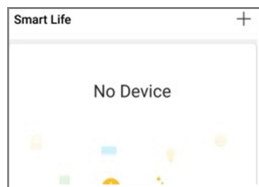

Step 4: Add Device

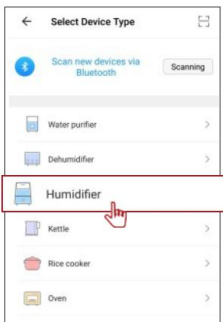

Step 5: Select Humidifier

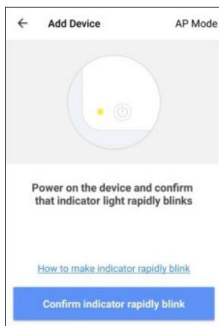

Step 6: Add Device

Attention:

1. In the registration process, the prompt "reset" button" is the "LIGHT" button of the device.
2. In step 6, please make sure WIFI indicator light rapidly flashing and then next step. If indicator light is not rapidly flashing, tap "How to make indicator rapidly blink" to view operation processes.

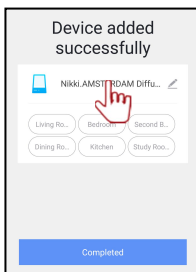

Step 7: Modify The Name

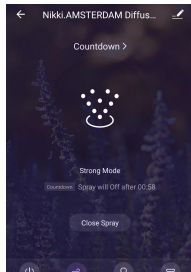

Step 8: Enter The Control Page

2. Entry into Smart APP Homepage

Spray

1.Settle mist working time.

2.Control spray open / close.

3.Set Spray Mode- Strong Mode / Small Mode.

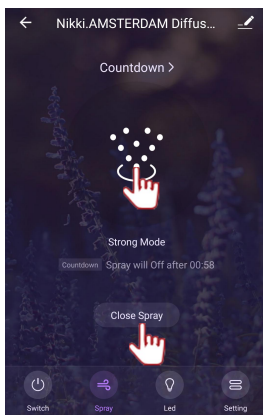
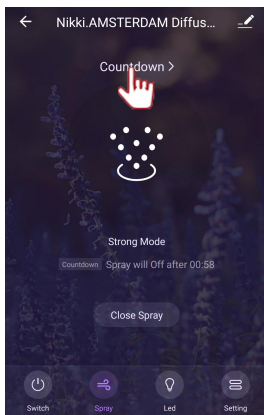

LED

1.Set LED color - color changing / select color.

2.Click the circle and select one color.

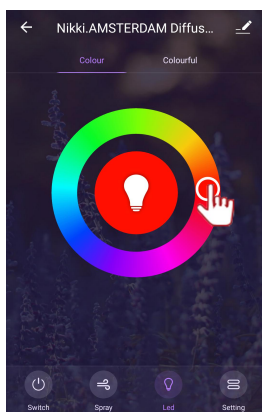

Timer

1.Set the mist time or light time.

2.Adjustment mist time.

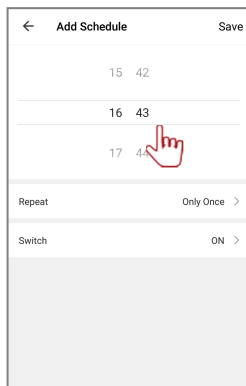
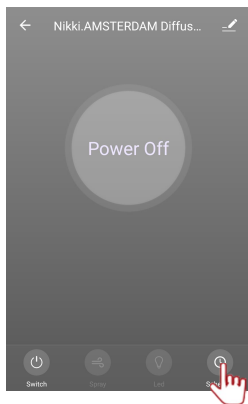

3. Configure Amazon Echo



Step1: Open The Alexa APP,Entry

Amazon account and code.

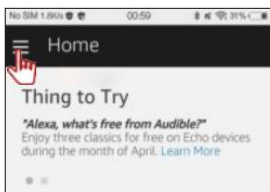

Step2: Load in successfully on Homepage.

Click the settings and set up a new device to set your Echo device.

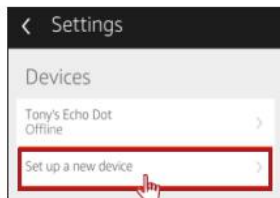
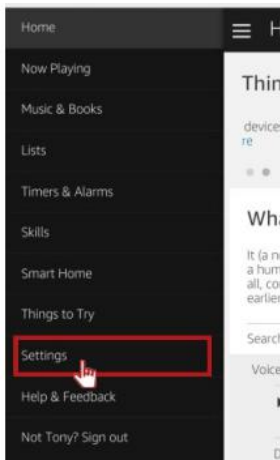

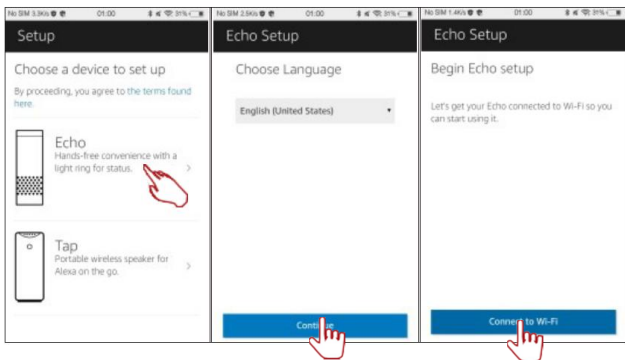

Step3: Choose Device

Step4: Choose Language

Step5: Connected To WIFI

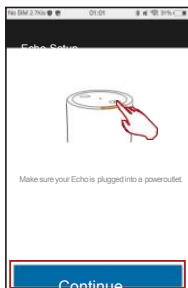

Step6: Keep pressing on-off button and light color turn to yellow. Then click Echo on-off

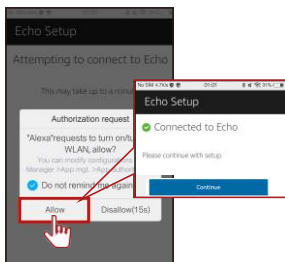

Step7: Select Allow, your phone will auto connect to Echo Wlan.

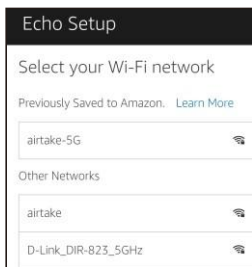

Step8: Select WIFI then connect to Echo.

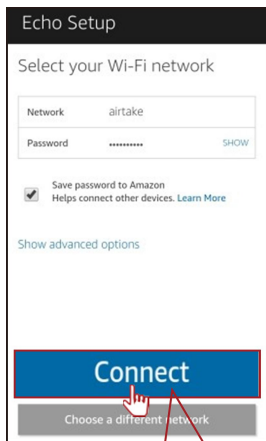

Step9: Entry WIFI code. Echo will take a few minutes to connect to WIFI.

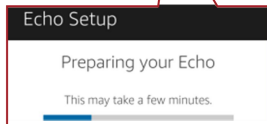



Step10: Connect to WIFI successfully,
then click continue.

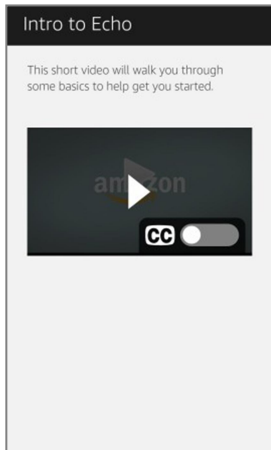

Step11: After the video is finished, click
continue to Alexa Homepage.

4.Binding your Echo with Smart Account

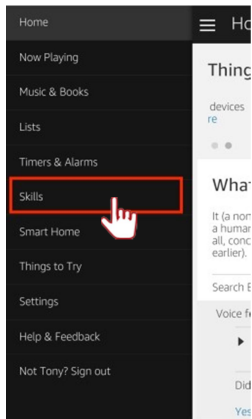

4.1 Click Skills

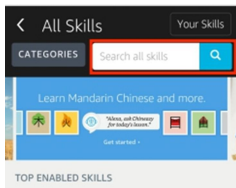

4.2 Search Smart Life

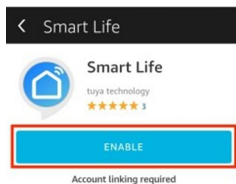

4.3 Click Enable To Start Skill



4.4 Entry App's account and code and to link.

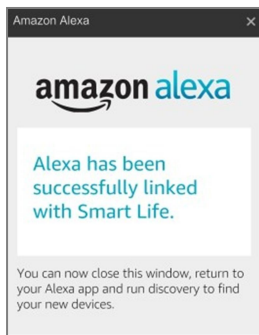

4.5 When App prompt "Alexa has been successfully linked with Smart Life", account have been binding successfully. Click top right corner ✕ to Alexa App

5. Echo – voice control your device

5.1 Searching Device

You can voice control your Echo"Alexa, discover device". Echo will search the device in "Create Group". You can also check Alexa APP with Smart Home to discover device.

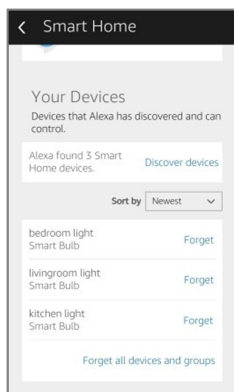
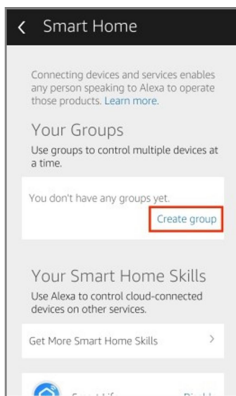

5.2 Voice Control The Device

You can use Echo to control your smart device. For example:

Alexa, turn on/off diffuser.

Alexa, turn on/off light.

Alexa, set light to red/green/blue/yellow/purple.

5.3 Create Group

“Create Group” means Alexa can control the all your devices they are in this group

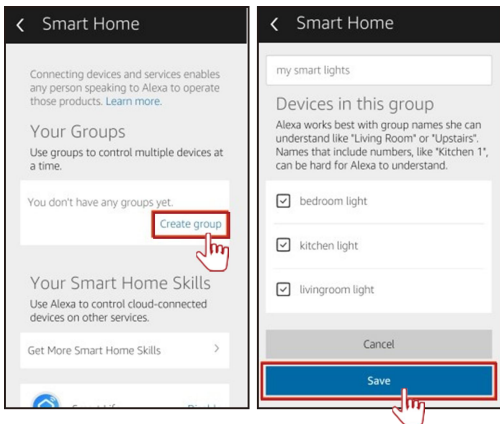

Attention:

1. Make sure your Smart account and Alexa account are correct and have been binding already.
2. Rename the device at Smart APP, Echo will need to reconnect the device.
3. Make sure your Echo device is connected with electricity.
4. Unobstructed WIFI for Echo device to connect.
5. Voice control all the device in “Create Group”.

CARE & MAINTENANCE

PRECAUTIONS:

Always unplug adaptor from aroma diffuser before performing any maintenance.

1.Clean water tank before using different essential oil.**Please keep to use NKKI. AMSTERDAM the essentials oil.**

2.Clean water tank and water stopper with a soft cloth if necessary.

3.Clean off any sediment (white mineral deposits and debris) from the atomizer with a soft cloth. Do not use any metal object to scrape the atomizer.

4.Do not rinse the device or soak the device in water.

5.Clean device surface with a soft cloth.

6.You can clean plastic case with water but avoid using any sharp object.